

	1	2	3	4		
A				版本REV		
				繪制日期		
B				A		
				2009-2-18		
C						
	<p>NOTE:</p> <p>1.THICKNESS: 0.20mm 2.MATERIAL: Phosphor Bronze/BRASS 3.FINISH: TIN PIATED /GOOD FLASH 4.APPLICABLE WIRE:AWG18-22 5.使用量具為電子卡尺</p>					
E	一般公差:GENERAL TOLERANCE		更改說明:REV.DESCRPTION		更改說明:REV.DESCRPTION	
	尺寸範圍DIM		△1		△1	
	.0	±0.30	△2		△2	
	.00	±0.20	△3		△3	
	.000	±0.10	核准APPD	朱小华	2009-2-18	模型: 料號: ITEM NO
	文件編號		審核CHD			
	SC-A-2500T		繪圖DWN	LIAOZTING	2009-2-18	
比例: SCALE					規格: SPEC 3.96mm Crimp Style Connector(VH3.96)	

1

2

3

4

版本REV

繪制日期

A

2009-3-28

A

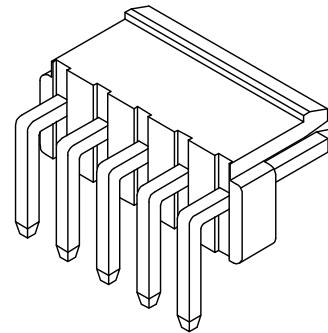
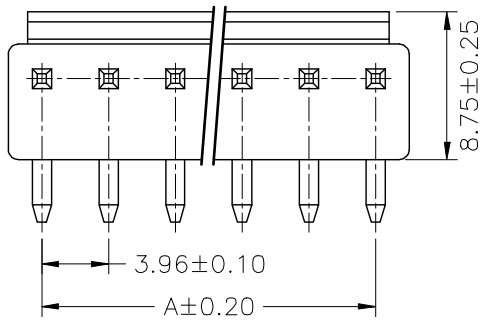

B

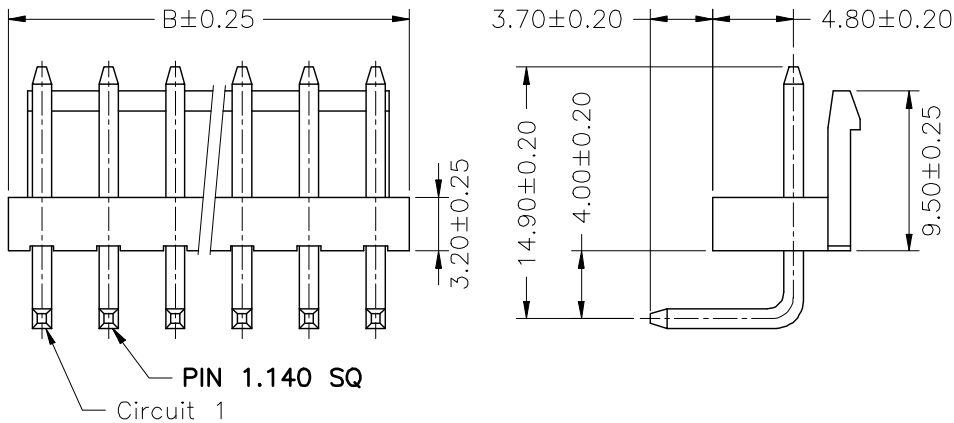

C

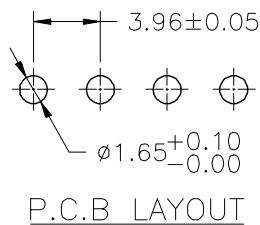

D

NOTE:

- Welding Board Angle: R-Right Angle 90°
- Material: PA66 UL94V-0
- Material(Pin): Brass
- Finish(Pin): Tin-Plated
- Row No.-Pin No.: NP-02P-15P

Circuit NO.	Dimensions	
	A	B
02P	3.96	7.92
03P	7.92	11.88
04P	11.88	15.84
05P	15.84	19.80
06P	19.80	23.76
07P	23.76	27.72
08P	27.72	31.68
09P	31.68	35.64
10P	35.64	39.60
11P	39.60	43.56
12P	43.56	47.52
13P	47.52	51.48
14P	51.48	55.44
15P	55.44	59.40

E

一般公差: GENERAL TOLERANCE

更改說明: REV. DESCRIPTION

更改說明: REV. DESCRIPTION

尺寸範圍DIM



10.01以上之尺寸

±0.20



10.00以內之尺寸

±0.15



孔位

±0.10



文件編號

核准APPD

朱小华

2009-3-28

模型:

料號: ITEM NO

SC-EW-11

審核CHD

Liaozting

2009-3-28

MODEL

A3961WR00-NP

比例: SCALE



SHIH CHUAN ELECTRONICS

規格: SPEC

3.96mm Crimp Style Connectors (VII3.96)

1

2

3

4

版本REV

繪制日期

A

2009-3-28

A

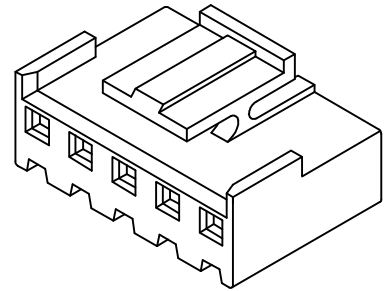
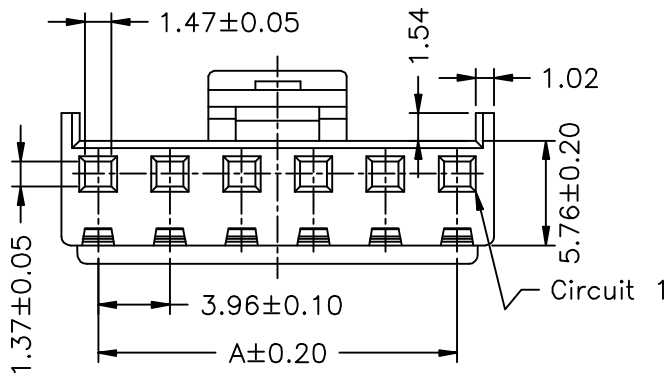

B

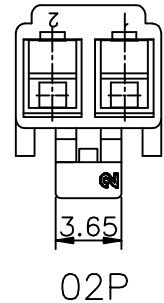
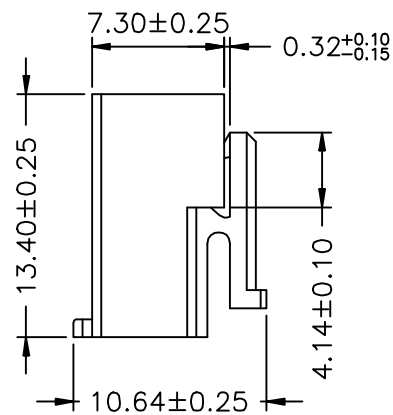
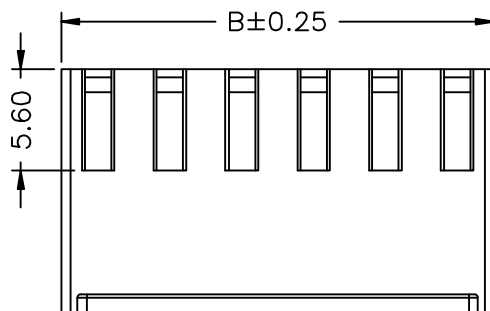

C

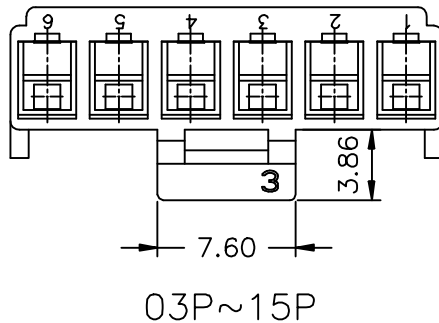

D

NOTE:

- Material: PA66 94V-0
- Row No.-Pin No.: NP-2P-15P

Circuit No.	Dimensions		Circuit No.	Dimensions	
	A	B		A	B
02P	3.96	8.02	09P	31.68	35.74
03P	7.92	11.98	10P	35.64	39.70
04P	11.88	15.94	11P	39.60	43.66
05P	15.84	19.90	12P	43.56	47.62
06P	19.80	23.86	13P	47.52	51.58
07P	23.76	27.82	14P	51.48	55.54
08P	27.72	31.78	15P	55.44	59.50

E

一般公差: GENERAL TOLERANCE

更改說明: REV. DESCRIPTION

更改說明: REV. DESCRIPTION

尺寸範圍DIM



10.01以上之尺寸

±0.20



10.00以內之尺寸

±0.15



孔位

±0.10

核准APPD

朱小华

2009-3-28

模型:

料號: ITEM NO

文件編號

審核CHD

MODEL

A3961H00-NP

SC-EW-11

繪圖DWN

Liaozting

2009-3-28

比例: SCALE



SHIH CHUAN ELECTRONICS

規格: SPEC

3.96mm Crimp Style Connectors (VHS.96)

1

2

3

4

版本REV

繪制日期

A

2009-3-28

A

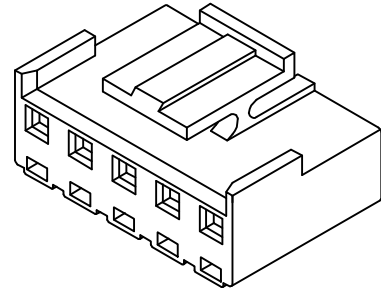
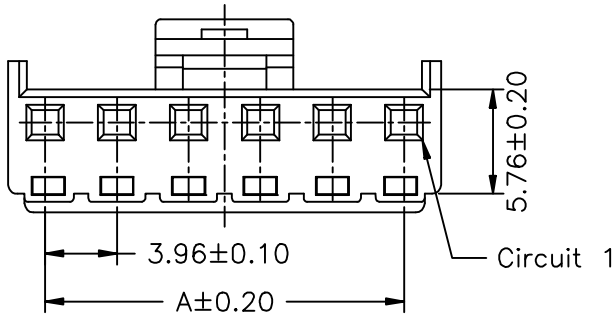

B

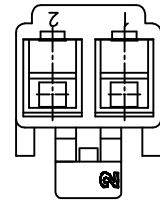
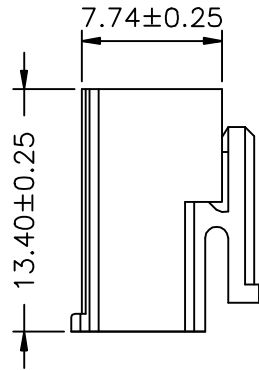
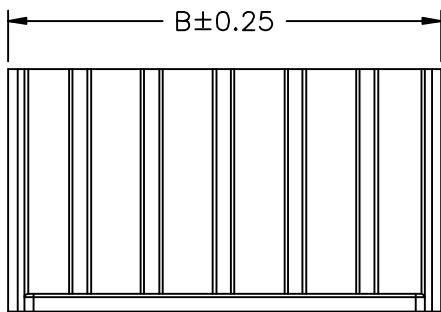

02P

C

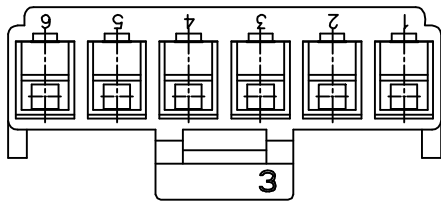

03P~15P

D

NOTE:

- Material: PA66 94V-0
- Row No.-Pin No.: NP-2P-15P

Circuit No.	Dimensions		Circuit No.	Dimensions	
	A	B		A	B
02P	3.96	8.02	09P	31.68	35.74
03P	7.92	11.98	10P	35.64	39.70
04P	11.88	15.94	11P	39.60	43.66
05P	15.84	19.90	12P	43.56	47.62
06P	19.80	23.86	13P	47.52	51.58
07P	23.76	27.82	14P	51.48	55.54
08P	27.72	31.78	15P	55.44	59.50

一般公差: GENERAL TOLERANCE

更改說明: REV. DESCRIPTION

更改說明: REV. DESCRIPTION

尺寸範圍DIM

①

④

10.01以上之尺寸

±0.20

②

⑤

10.00以內之尺寸

±0.15

③

⑥

孔位

±0.10

核准APPD

朱小华

2009-3-28

模型:

料號: ITEM NO

文件編號

審核CHD

MODEL

A3961H00-A-NP

SC-EW-11

繪圖DWN

Liaozting

2009-3-28

比例: SCALE



SHIH CHUAN ELECTRONICS

規格: SPEC

3.96mm Crimp Style Connectors (VIB. 96)

E

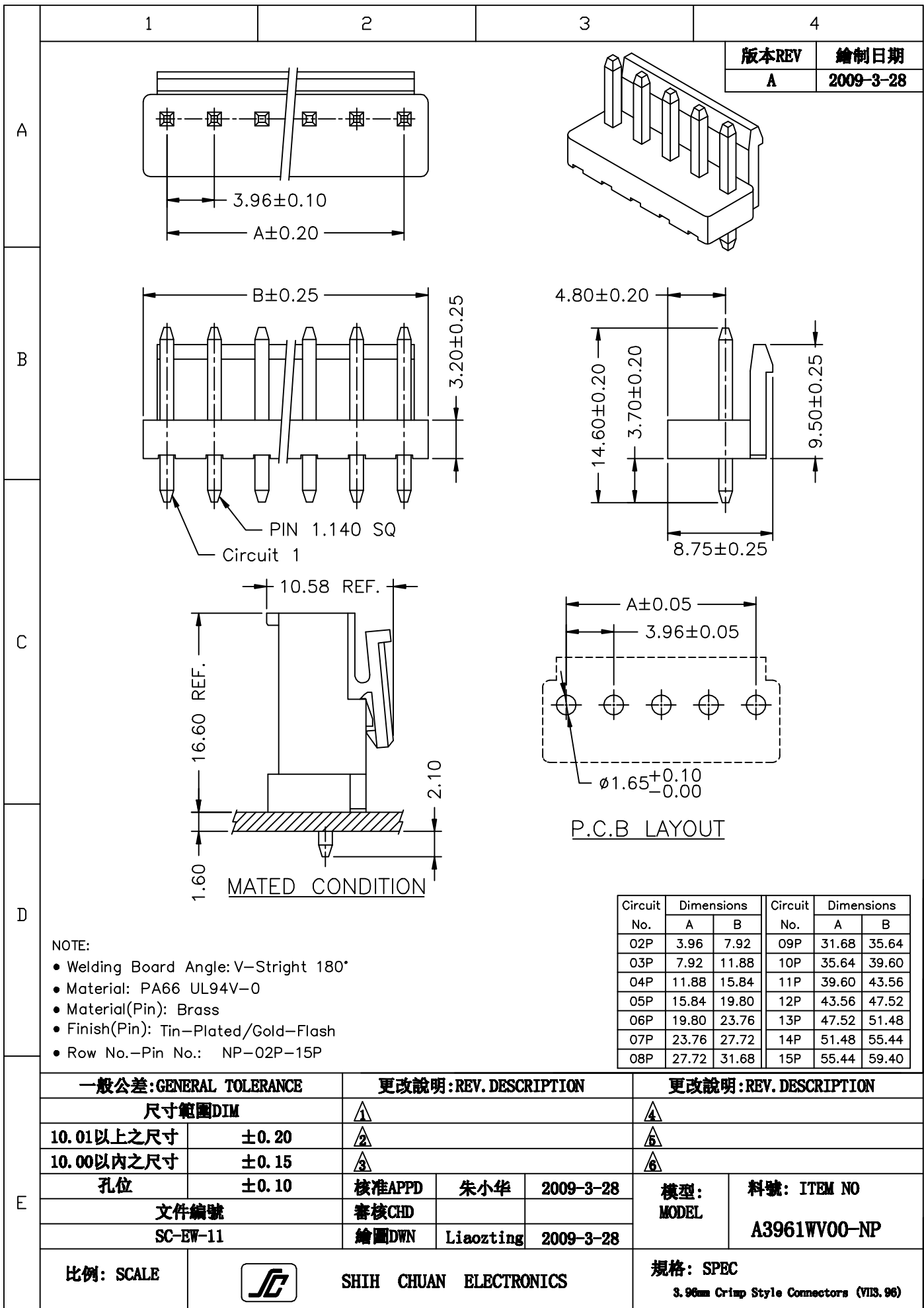

版本REV	繪制日期
A	2009-3-28

NOTE:

- Welding Board Angle: V-Stright 180°
- Material: PA66 UL94V-0
- Material(Pin): Brass
- Finish(Pin): Tin-Plated/Gold-Flash
- Row No.-Pin No.: NP-02P-15P

Circuit No.	Dimensions		Circuit No.	Dimensions	
	A	B		A	B
02P	3.96	7.92	09P	31.68	35.64
03P	7.92	11.88	10P	35.64	39.60
04P	11.88	15.84	11P	39.60	43.56
05P	15.84	19.80	12P	43.56	47.52
06P	19.80	23.76	13P	47.52	51.48
07P	23.76	27.72	14P	51.48	55.44
08P	27.72	31.68	15P	55.44	59.40

一般公差: GENERAL TOLERANCE

更改說明: REV. DESCRIPTION

更改說明: REV. DESCRIPTION

尺寸範圍DIM

10.01以上之尺寸

± 0.20

10.00以內之尺寸

± 0.15

孔位

± 0.10

文件編號

SC-EW-11

核准APPD

朱小华

2009-3-28

審核CHD

繪圖DWN

Liaozting

2009-3-28

模型:

MODEL

料號: ITEM NO

A3961WV00-NP

比例: SCALE



SHIH CHUAN ELECTRONICS

規格: SPEC

3.96mm Crimp Style Connectors (VII3.96)